

CDB • PDB

partidos polivalentes - túneles de congelación



partido
suelo
túnel de congelación • polivalentes
R404A



CDB



PDB



LOS MODELOS **CDB** Y **PDB** SE CARACTERIZAN POR SU CONSTRUCCIÓN TIPO **PARTIDO**.

LOS MODELOS DE LA SERIE **CDB** SE CARACTERIZAN POR SER UTILIZADOS PARA **TÚNELES DE CONGELACIÓN** E INCORPORAN COMPRESORES **SEMI-HERMÉTICOS DE DOBLE ETAPA** DE TIPO **ALTERNATIVO**.

LOS EQUIPOS **PDB** SON EQUIPOS POLIVALENTES QUE AÑADEN LA POSIBILIDAD DE UTILIZAR LA CÁMARA EN FUNCIONAMIENTO **TANTO DE MEDIA** COMO DE **BAJA** TEMPERATURA.

LOS EQUIPOS CUENTAN CON:

- ▶ COMPRESORES HERMÉTICOS O SEMIHERMÉTICOS (SEGÚN MODELOS)
- ▶ PRESOSTATO DE ALTA
- ▶ PRESOSTATO DE BAJA
- ▶ FILTRO DESHIDRATADOR
- ▶ VISOR DE LÍQUIDO
- ▶ ANTIVIBRADOR EN DESCARGA
- ▶ ANTIVIBRADOR EN ASPIRACIÓN
- ▶ RECIPIENTE DE LIQUIDO CON VÁLVULA DE SEGURIDAD
- ▶ SEPARADOR DE ASPIRACIÓN (SOLO PDB)
- ▶ VÁLVULA REGULADORA DE PRESIÓN (SOLO PDB)
- ▶ PARO EN PUMP-DOWN
- ▶ PRESOSTATO DE ACEITE
- ▶ CONTROL DE CONDENSACIÓN POR PRESOSTATOS
- ▶ RESISTENCIA DE PRECALENTAMIENTO
- ▶ DESESCARCHE ELÉCTRICO COMPLETAMENTE AUTOMÁTICO
- ▶ VÁLVULA DE EXPANSIÓN MONTADA EN EVAPORADOR
- ▶ PANEL DE CONTROL REMOTO 5 MTS
- ▶ CUADRO ELÉCTRICO CON PROTECCIÓN MAGNETOTÉRMICA

DIMENSIONES

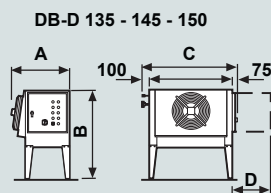

| mm | A | B | C | D |
|---------|-----|-----|-------|-----|
| DB 225D | 594 | 898 | 840 | 370 |
| DB 135D | 630 | 996 | 630 | 400 |
| DB 235D | 630 | 996 | 1.200 | 400 |

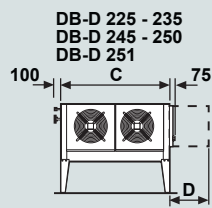

| mm | A | B | C | D |
|---------|-------|-------|-------|-----|
| DB 145D | 870 | 1.290 | 1.070 | 565 |
| DB 150D | 870 | 1.290 | 1.220 | 565 |
| DB 245D | 870 | 1.290 | 1.600 | 565 |
| DB 250D | 1.070 | 1.465 | 1.800 | 750 |

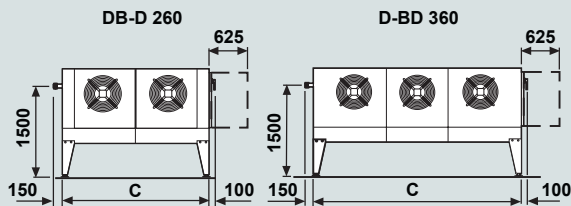

| mm | A | B | C | D |
|---------|---|---|-------|---|
| DB 260D | - | - | 2.400 | - |
| DB 360D | - | - | 3.400 | - |

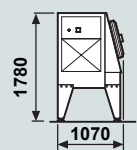

OPCIONALES

Para obtener rendimientos a +40°C o +45° aplicar la siguiente fórmula reducida:

$$V_{+45} = 0,85 V_{+35} \quad Pot_{+45} = 0,85 Pot_{+35}$$

$$V_{+40} = 0,93 V_{+35} \quad Pot_{+40} = 0,93 Pot_{+35}$$

base cálculo

| | Media | Baja | |
|----------------------------------|-------|------|-------------------|
| AISLAMIENTO | 80 | 100 | mm |
| DENSIDAD DE CARGA | 250 | 250 | kg/m ³ |
| MOVIMIENTO MERCANCIA | 10% | 10% | |
| TEMPERATURA ENTRADA MERCANCIA | 25 | -5 | °C |
| CALOR ESPECÍFICO DE LA MERCANCIA | 0,77 | 0,44 | kcal/kg°C |
| HORAS DE TRABAJO DEL COMPRESOR | 18 | 18 | horas |
| TEMPERATURA EXTERIOR | 35 | 35 | °C |

polivalente **P**

túneles **T**

| | | |
|---------|-------|---|
| VVE TER | 541 € | VARIADOR DE VELOCIDAD TERMOSTÁTICO PARA CONTROL DE CONDENSACIÓN |
| VVE PRS | 714 € | VARIADOR DE VELOCIDAD PRESOSTÁTICO PARA CONTROL DE CONDENSACIÓN |
| VVE BCO | 555 € | VARIADOR DE VELOCIDAD BEST COP (MENOS LOS MODELOS BX) |
| FRS EVP | 5% | CATAFORESIS EN EVAPORADOR |
| FRS CND | 5% | CATAFORESIS EN CONDENSADOR |
| MON TEN | 277 € | MONITOR DE TENSIÓN |

| | | |
|---------|-------|--|
| VOL DIF | 5% | CAMBIO DE VOLTAJE |
| CND H2O | 5% | CONDENSACIÓN POR AGUA |
| IMB LEG | 3% | EMBALAJE DE MADERA |
| PAN MUL | 849 € | MANDO A DISTANCIA MÚLTIPLE PARA CONTROLAR HASTA 4 EQUIPOS EN LA MISMA CÁMARA |

SIS TLG 550 € SISTEMA DE GESTIÓN DE ALARMAS VÍA E-MAIL [PRECIO NETO]

P polivalente

| TIPO HP | COMPR.* | VOLTAJE | CONSUMO kW | CARGA GAS kg | PRECIO | 0°C | | -20°C | | CAUDAL CND m ³ /h | CAUDAL EVP m ³ /h | POT. DESC kW | COMPRESOR | |
|------------------------|---------|---------|------------|--------------|--------|-----------------|----------------|-------|----------------|------------------------------|------------------------------|--------------|-----------|----------|
| | | | | | | Watt | m ³ | Watt | m ³ | | | | | |
| NEW PDB221TO..F | 2 | H | 400/3N~/50 | 2,38 | 2,00 | 4.800 € | 2.108 | 24 | 1.681 | 17 | 1.400 | 1.200 | 0,8 | MTZ 32 |
| PDB135T765F | 3 | H | 400/3N~/50 | 3,40 | 3,00 | 9.078 € | 3.711 | 45 | 2.625 | 29 | 2.150 | 2.300 | 3,25 | MTZ 50 |
| PDB235T765F | 5 | SH | 400/3N~/50 | 5,10 | 6,00 | 15.046 € | 6.707 | 95 | 5.405 | 89 | 3.800 | 4.300 | 4,27 | Q733Y |
| NEW PDB335TS..F | 7,5 | S | 400/3N~/50 | 7,60 | 10,00 | 15.560 € | 9.271 | 155 | 8.361 | 166 | 8.000 | 6.400 | 4,10 | ZF24EVI |
| NEW PDB340NS..F | 13 | S | 400/3N~/50 | 8,70 | 12,00 | 16.175 € | 11.154 | 194 | 9.917 | 211 | 8.000 | 8.400 | 4,90 | ZF40 |
| NEW PDB340TS..F | 15 | S | 400/3N~/50 | 11,80 | 12,00 | 19.262 € | 12.973 | 233 | 11.558 | 261 | 8.000 | 8.000 | 4,90 | ZF48 |
| NEW PDB435TS..F | 15 | S | 400/3N~/50 | 16,40 | 15,00 | 23.605 € | 19.686 | 383 | 18.709 | 510 | 16.000 | 14.300 | 11,30 | ZF48EVI |
| NEW PDB440NS..F | 26 | S | 400/3N~/50 | 18,00 | 15,00 | 27.644 € | 22.943 | 457 | 21.523 | 609 | 16.000 | 20.000 | 12,70 | 2xZF40 |
| NEW PDB440TS..F | 30 | S | 400/3N~/50 | 22,30 | 15,00 | 29.781 € | 25.760 | 528 | 24.933 | 729 | 16.000 | 21.900 | 17,16 | 2xZF48 |
| PDB260T765F | 60 | SH | 400/3N~/50 | 31,50 | 50,00 | 66.212 € | 41.692 | 1.028 | 33.958 | 1.179 | 22.300 | 21.800 | 21,6 | 44G60.2Y |
| PDB360T765F | 80 | SH | 400/3N~/50 | 39,00 | 60,00 | 82.645 € | 62.934 | 1.607 | 51.692 | 1.944 | 33.300 | 32.800 | 32,1 | 66G80.2Y |

* H = HERMÉTICO • SH = SEMIHERMÉTICO • S=SCROLL

T túneles de congelación

| TIPO HP | VOLTAJE | CONSUMO kW | CARGA GAS kg | PRECIO | R404A | | | | CAUDAL CND m ³ /h | CAUDAL EVP m ³ /h | POT. DESC kW | TUBERIA LIQ - ASP | |
|---------------|---------|------------|--------------|--------|------------------|----------------------|------------|----------------------|------------------------------|------------------------------|--------------|-------------------|-------------|
| | | | | | -35°C Watt | -40°C m ³ | -45°C Watt | -50°C m ³ | | | | | |
| CDB150N765F | 7,5 | 400/3/50 | 6,9 | 8,00 | 26.369 € | 5.974 | 4.862 | 3.897 | 3.080 | 6.800 | 7.300 | 8,80 | 1/2 1-3/8 |
| CDB150T765F | 10 | 400/3/50 | 10,2 | 8,00 | 27.987 € | 8.478 | 6.952 | 5.570 | 4.399 | 6.800 | 7.300 | 8,80 | 1/2 1-3/8 |
| CDB250N765F | 15 | 400/3/50 | 13,6 | 18,00 | 45.356 € | 18.904 | 15.755 | 12.903 | 10.381 | 13.700 | 15.300 | 17,65 | 5/8 1-5/8 |
| CDB250T765F | 25 | 400/3/50 | 23,9 | 18,00 | 49.929 € | 24.914 | 20.786 | 17.042 | 13.728 | 13.700 | 15.300 | 17,65 | 5/8 2-1/8 |
| CDB260T3765F | 30 | 400/3/50 | 31,5 | 30,00 | 76.446 € | 29.532 | 24.667 | 20.258 | 16.347 | 22.300 | 26.900 | 25,71 | 7/8 2-1/8 |
| CDB260T4765F | 40 | 400/3/50 | 31,5 | 35,00 | 103.204 € | 43.626 | 36.375 | 29.806 | 23.998 | 22.300 | 26.900 | 25,71 | 7/8 2-5/8 |
| CDB260T5765F | 50 | 400/3/50 | 31,5 | 55,00 | 106.878 € | 49.828 | 41.572 | 34.084 | 27.455 | 22.300 | 25.900 | 25,71 | 7/8 2-5/8 |
| CDB360T765F | 75 | 400/3/50 | 39,0 | 70,00 | 153.488 € | 74.742 | 62.358 | 51.126 | 41.183 | 33.300 | 39.000 | 38,28 | 1-1/8 3-5/8 |
| CDB730BR765F | 30 | 400/3/50 | 19,7 | 50,00 | 63.275 € | 29.532 | 24.667 | 20.258 | 16.347 | 25.200 | 24.920 | 25,00 | 7/8 2-1/8 |
| CDB940BR765F | 40 | 400/3/50 | 32,6 | 45,00 | 93.919 € | 43.626 | 36.375 | 29.806 | 23.998 | 60.200 | 34.810 | 29,00 | 7/8 2-5/8 |
| CDB950BR765F | 50 | 400/3/50 | 38,7 | 75,00 | 102.528 € | 49.828 | 41.572 | 34.084 | 27.455 | 56.600 | 55.000 | 36,00 | 7/8 2-5/8 |
| CDB1075BR765F | 70 | 400/3/50 | 55,9 | 100,00 | 135.567 € | 74.742 | 62.358 | 51.126 | 41.183 | 75.500 | 73.330 | 34,00 | 1-1/8 3-5/8 |

* COMPRESOR DOBLE ETAPA TODOS LOS MODELOS

DIMENSIONES

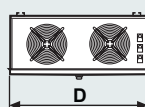
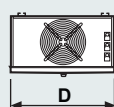
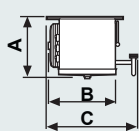

DB-D 135
DB-D 145
DB-D 150

DB-D 225 - 235
DB-D 245 - 250
DB-D 251

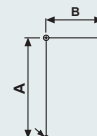

| mm | A | B | C | D |
|----------|-----|-----|-----|-------|
| DB 225-D | 455 | 413 | 560 | 960 |
| DB 135-D | 545 | 520 | 690 | 805 |
| DB 235-D | 505 | 520 | 690 | 1.165 |
| DB 145-D | 670 | 771 | 950 | 1.039 |
| DB 150-D | 670 | 771 | 981 | 1.189 |
| DB 245-D | 670 | 771 | 992 | 1.569 |
| DB 250-D | 844 | 771 | 992 | 1.769 |

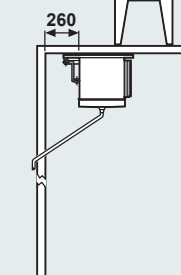
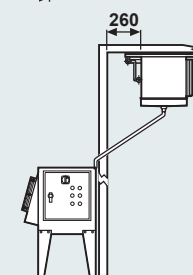

ø12 n° 4
Agujero fijación evaporador

